

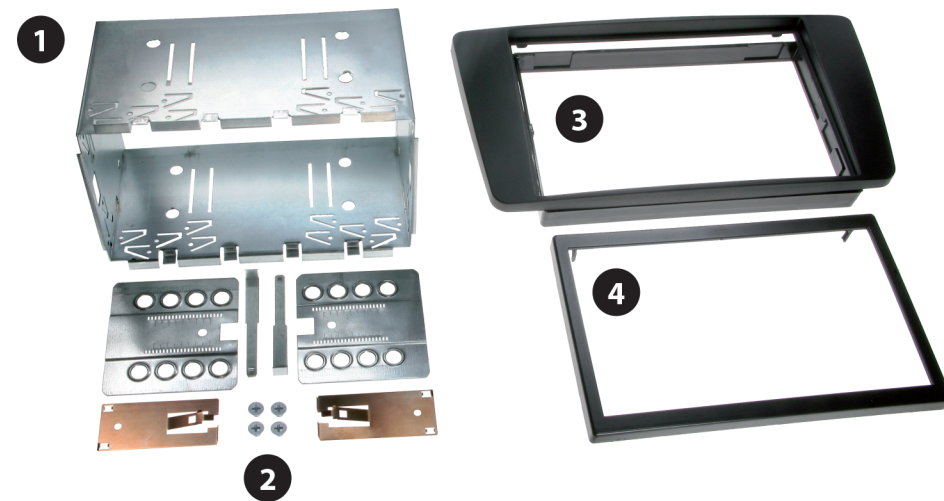

• **Škoda Octavia II 2004 →**

Compatible with these double DIN devices



Double DIN Set contents

- (1) Metal Frame
- (2) Installation Kit
- (3) Facia Plate / Mounting frame
- (4) Trim Frame



1. Remove dashboard panel.



2. Remove 4 screws fixing the OEM head unit.
Remove OEM head unit.



3. Place mounting frame on the dashboard and fix it with the original screws.

Push the metal frame into the mounting frame.

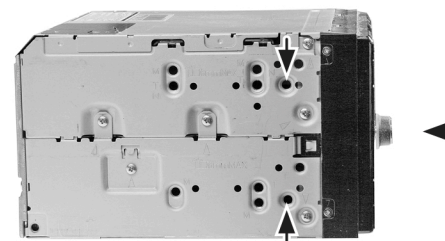

(sample photo)

Mount the metal brackets to the double DIN head unit.

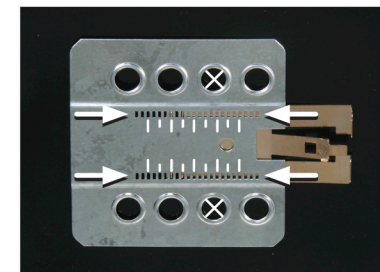

(sample photo)

The position of the copper coloured holder can be adjusted to your needs for perfect fit. (see sample)



4. Connect all required circuit points and push the double DIN head unit in the metal frame until it snaps in.

Place the facia plate on the dashboard.

Place the trim frame.
Reinstall everything in reverse order to finish installation.