

APPLICATIONS

KIA Borrego 2009

CT23KI19

KIT FEATURES

- DIN Radio Provision
- ISO DIN Radio Provision
- Double DIN Radio Provision
- Stacked ISO Mount Units Provision



KIT COMPONENTS

- A) Radio Housing • B) ISO Trim Plate • C) ISO Brackets • D) Double DIN Trim Plate
• E) Double DIN Brackets • F) Pocket

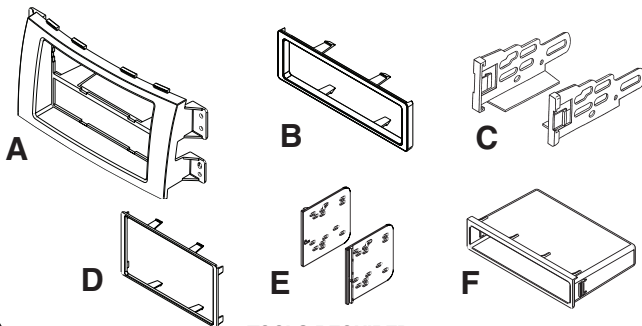

TOOLS REQUIRED:

- Small Flat Blade Screwdriver/ Panel Removal Tool
• Phillips Screwdriver





TABLE OF CONTENTS

Dash Disassembly

- KIA Borrego 2009 1

Kit Assembly

- DIN Radio Provision 2
- ISO Mount Radio Provision 3
- Double DIN/Stacked ISO Mount Units Provision. 4

Final Assembly 5

***Note:**

Refer also to the instructions included with the aftermarket radio.

KIA BORREGO 2009

- 1** Disconnect the negative battery terminal to prevent an accidental short circuit.
- 2** Unclip and remove the side trim panels. (Figure A)
- 3** Remove (4) Phillips screws securing the radio and (2) Phillips screws securing the A/C vent panel above the radio. (Figure B)
- 4** Unclip and remove the radio and A/C vent panel as one piece then unplug the radio and vent panel and separate. (Figure C)

Continue to kit assembly.

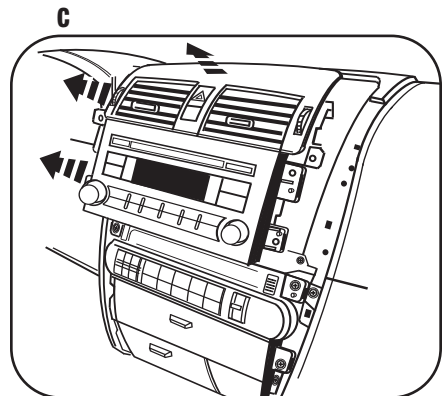
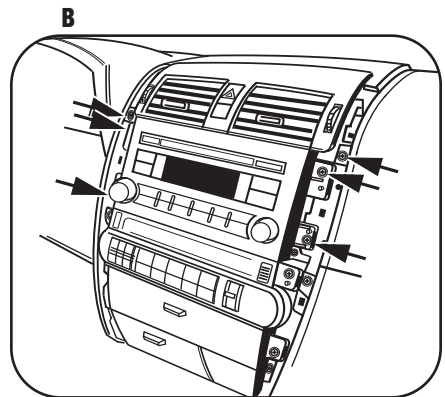
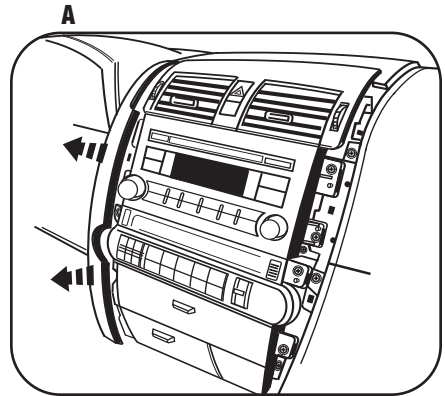

DIN RADIO PROVISION

**Note: Refer also to the instructions included with the aftermarket radio.*

- 1** Slide the DIN cage into the Radio Housing and secure by bending the metal locking tabs outward. (Figure A)
- 2** Slide the aftermarket radio into the cage until it snaps into place. (Figure B)
- 3** Snap the pocket into the bottom opening of the radio housing. (Figure C)

Continue to final assembly.

A

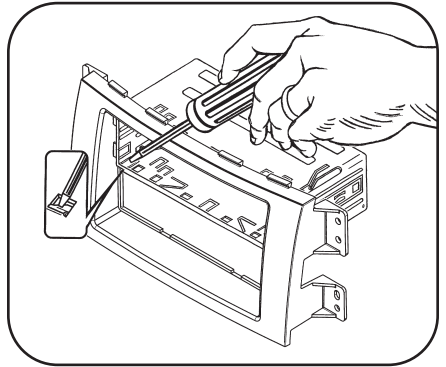

B

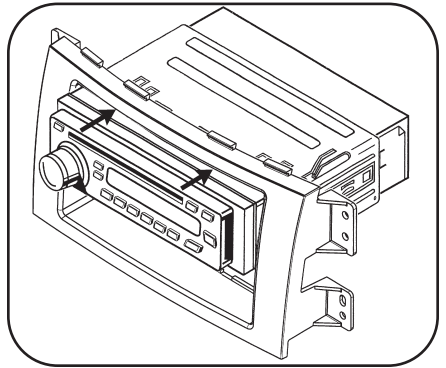

C

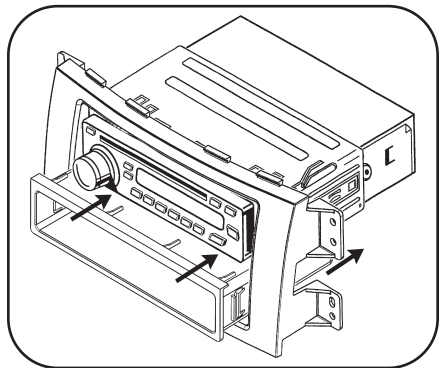

ISO MOUNT RADIO PROVISION

**Note: Refer also to the instructions included with the aftermarket radio.*

- 1 Mount the ISO Brackets to the radio using the screws supplied with the radio. (Figure A)
- 2 Slide the radio/bracket assembly into the radio housing until it snaps into place. (Figure B)
- 3 Snap the ISO Trim plate onto the front of the Radio Housing. (Figure C)
- 4 Snap the pocket into the bottom opening of the radio housing. (Figure D)

Continue to final assembly.

A

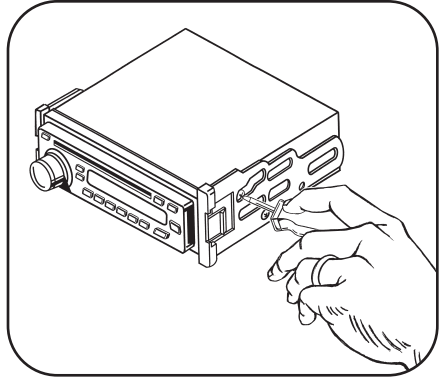

B

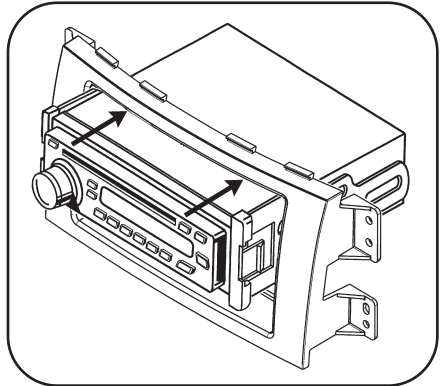

D

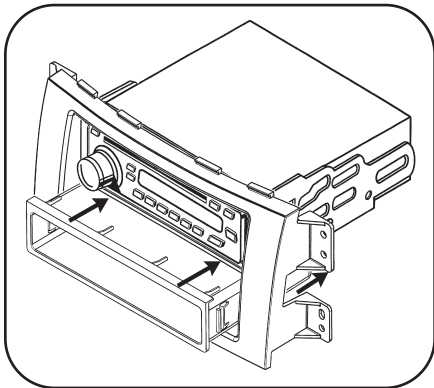

C

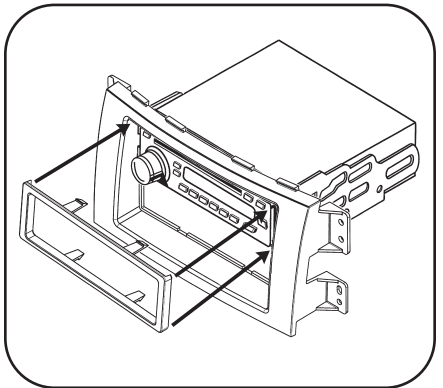

DOUBLE DIN/STACKED ISO MOUNT UNITS PROVISION

**Note: Refer also to the instructions included with the aftermarket radio.*

- 1 Cut and remove the center bar from the radio housing. (Figure A)
- 2 Snap the Double DIN brackets to the inside edge of the Radio Housing. (Figure B)
- 3 Slide the Double DIN or stacked ISO mount unit(s) into the bracket/radio housing assembly and secure the unit(s) to the assembly using the screws supplied with the unit(s). (Figure C)
- 4 Snap the Double DIN Trim plate onto the front of the Radio Housing. (Figure C)

Continue to final assembly.

